

# '52 Pickup

## Fixup your Pickup

**20**  
*minutes*

**2-4**  
*players*

This junkheap has all the parts you need to restore your 1952 Pickup.

Collect the right parts to sell to your fellow gearheads, but you'll have to dig them out before they do.

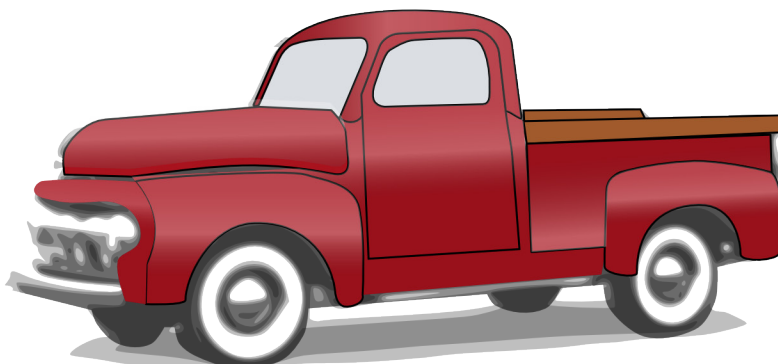

### How To Play

Collect cards from the pile, assemble them into trucks for points

Fenders score as a pair

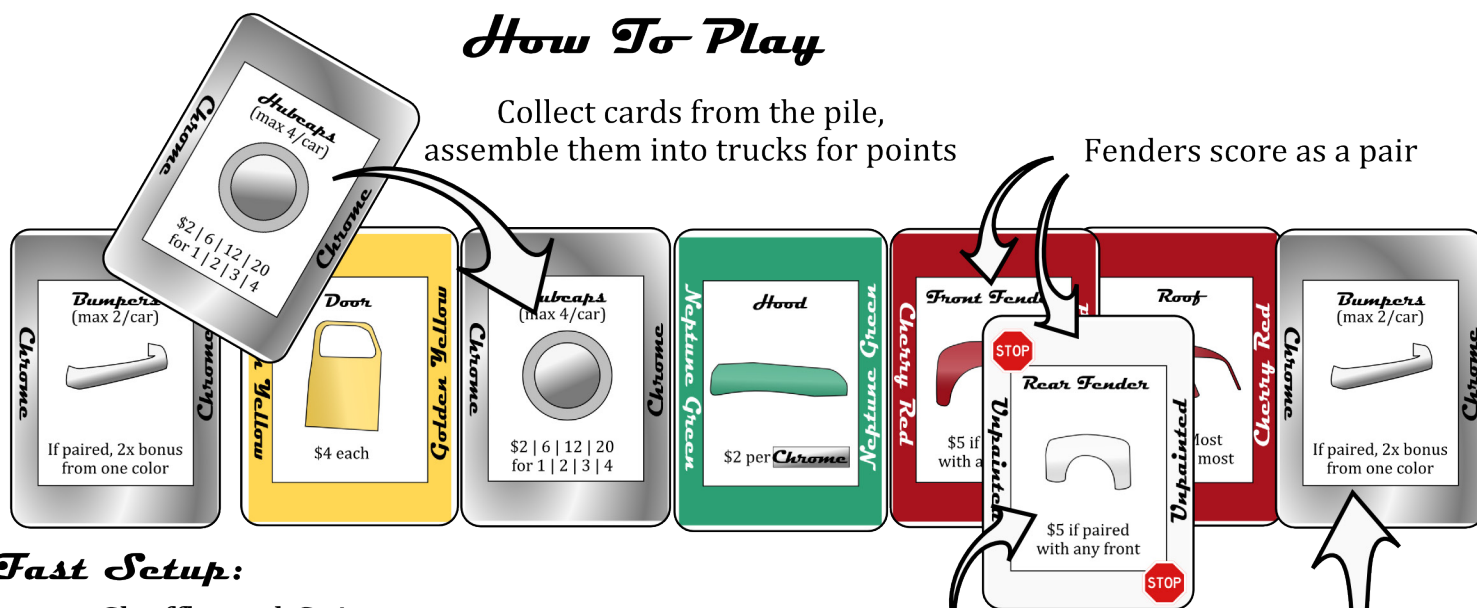

### Fast Setup:

Shuffle and Go!

### Easy to learn:

Collect sets of truck parts

### Quick to play:

Simple turns and fast decisions

### Replayable:

Work with the parts you can get

### Ready to expand:

Add more players, colors, parts, and powers for more variety

Unpainted parts take any color but bring the end game closer.

Score a bonus for 3 Cherry red parts!

A pair of Bumpers doubles the same color bonus

6. Add up the value of all your trucks and spare parts.

Complete a truck for another bonus.

This one's missing a side panel